

Christian County, KY PVA

Summary

Map Number/Account Number	218-00 06 025.00 / 69600034
Tax District	City of Hopkinsville (01)
Description	1705 S CAMPBELL ST (Note: Not to be used on legal documents)
Tax Rates	See Tax Rates
Location Address	1705 CAMPBELL ST S
Deed Book	722
Deed Page	430

[View Map](#)



Owner

[Brawner Dallas E](#)
1202 S Main St
Hopkinsville KY 42240

Value Information

		2023 Certified Tax Roll Assessment
Residential Value		\$18,000
Commercial Value		\$0
Mobile Home Value		\$0
Farm Tax Value		\$0
Farm Fair Cash Value		\$0
TC Build Value		\$0
TC Land Value		\$0
LS Hold Value		\$0
Homestead		No

Most Recent Sale

Sale Date	Sale Price	Deed Book	Deed Page	Previous Owner
3/10/2016	\$18,000	722	430	WALKER WILLIAM D ESTATE

Land Information

Class	RESIDENTIAL	Sidewalks	
Lot Size	0	Topography	
Frontage	0	Zoning Code	
Depth	0	Subdivision	
Acreage	0	Unit	
Type	RESIDENTIAL	Block	
Drive Type	G	Lot	
Flood Type		Land Value	\$0
Utility Type	W		

Residential Improvement Information

Res Type	SINGLE FMLY	Heat	GAS
Year Built	0	AC	NONE
Foundation	BRICK ON BLOCK	Total Rooms	0
Basement	NONE	Value	\$0
Exterior	VINYL	Living Sqft	1439
Bedrooms	3	Basement Sqft	0
Full Bath	1	Garage Sqft	0
Half Bath	0	Porch Sqft	0
Roof Cover	CPSN SHGLS	Patio/Deck Sqft	0
Roof Type	GABLE	Basement Finish	0
Res Cond		Structure	1 STORY
Fireplaces	1	Garage	DETTCHD CARPORT

Sale Information

Sale Date ↕	Sale Price ↕	Deed Book ↕	Deed Page ↕	Previous Owner ↕
3/10/2017	\$18,000	722	430	WALKER WILLIAM D ESTATE
3/10/2016	\$18,000	722	430	WALKER WILLIAM D ESTATE
11/1/1993	\$16,000			WALKER HAROLD E
3/1/1993	\$16,000			G P WALKER

Recent Sales In Area

Sale date range:

From:

01/01/2013

To:

08/28/2023

Recent Sales in Area

1500

Feet ▼

Sales by Distance

Photos



Sketches

Sketch Summary

GroundLiving=1439.00

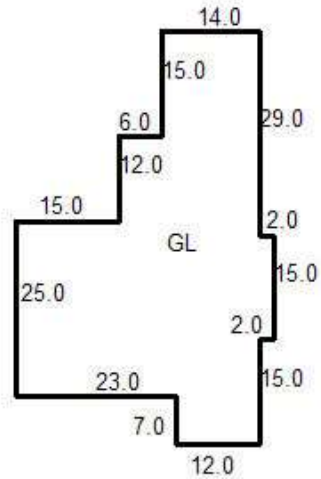

Scale: 1 inch = 30.0

No data available for the following modules: Mobile Home Information, Commercial Information.

The Christian County Assessor's Office makes every effort to produce the most accurate information possible.
No warranties, expressed or implied, are provided for the data herein, its use or interpretation.
| [User Privacy Policy](#) | [GDPR Privacy Notice](#)
[Last Data Upload: 8/15/2023, 3:39:01 PM](#)

[Contact Us](#)

Developed by
 **Schneider**
GEOSPATIAL