

# Bolinger

REAL ESTATE & AUCTION

110 John Rives Road  
Hopkinsville, KY 42240  
270-632-8882  
info@BolingerRealEstate.com  
BolingerRealEstate.com

**THURSDAY SEPT 30TH  
AT 6:00 PM**

**SEPTEMBER 2021**

Sunday	Monday	Tuesday	Wednesday	Thursday	Friday	Saturday
			1	2	3	4
5	6	7	8	9	10	11
12	13	14	15	16	17	18
19	20	21	22	23	24	25
26	27	28	29	30		

**\*SIMULCAST BIDDING AVAILABLE\***  
LIVE AUCTION HELD AT  
MILLIKEN COMMUNITY HOUSE  
208 W MAIN STREET, ELKTON, KY



**BEN BOLINGER**  
Broker/Auctioneer  
270.889.7648



**KELVIN DEBERRY**  
Realtor/Auctioneer  
270.604.2536



**PAUL WHISLER**  
Realtor/Auctioneer  
270.839.5935



**VULEZO BLOUNT**  
Realtor  
270.305.6997



**SCOTT SANDERS**  
Realtor  
270.339.6841



BOLINGERREALESTATE.COM | 270.632.8882 | INFO@BOLINGERREALESTATE.COM

**LIVE AUCTION HELD AT  
MILLIKEN COMMUNITY HOUSE  
208 W MAIN STREET, ELKTON, KENTUCKY**

ONLINE BIDDING AVAILABLE STARTING SEPT 22ND AT 5PM  
BOLINGERREALESTATE.COM

Bid Now

- COUNTY WATER & ELECTRIC AVAILABLE
- OVER 5,000 FT OF ROAD FRONTAGE ALONG CRITTENDEN RD
- HIGHLY PRODUCTIVE FARM GROUND
- \$300 PER ACRE ANNUAL CROP LEASE

**130 +/- Acres**  
9 TRACTS & COMBINATIONS

EXCELLENT BUILDING SITES OR HOBBY FARM OPPORTUNITIES IN RUSSELLVILLE, KY



# LAND AUCTION

**LIVE AUCTION  
THURSDAY  
SEPT 30TH, 2021  
6:00 PM**



# VIEW MORE INFORMATION & PLACE YOUR BID AT BOLINGERREALESTATE.COM

\*\* ONLINE BIDDER REGISTRATION FORM, DEPOSIT & APPROVAL REQUIRED \*\*

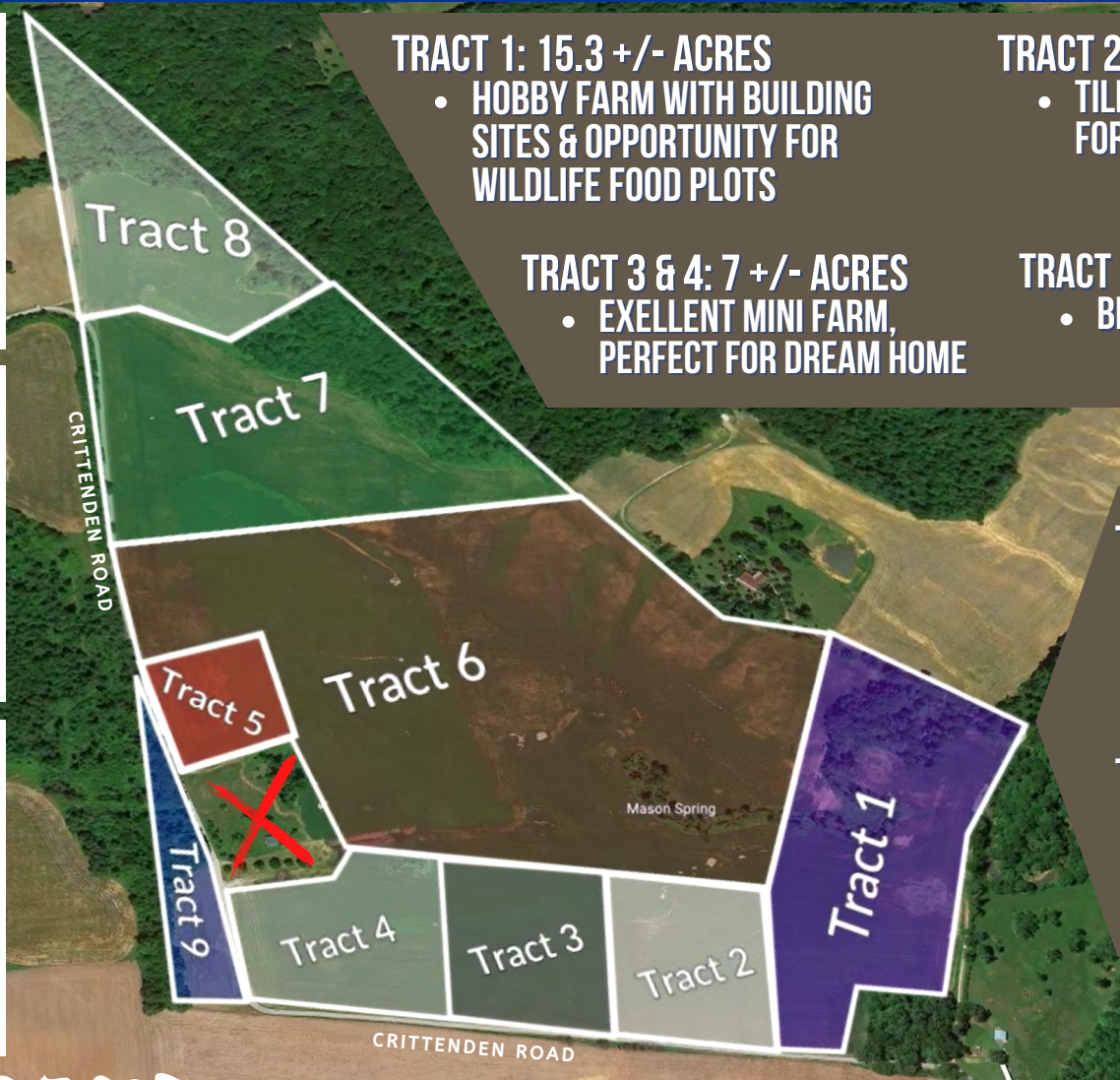

**TRACT 1: 15.3 +/- ACRES**

- HOBBY FARM WITH BUILDING SITES & OPPORTUNITY FOR WILDLIFE FOOD PLOTS

**TRACT 2: 11 +/- ACRES**

- TILLABLE TRACT, PERFECT FOR HOME & HORSES

**TRACT 3 & 4: 7 +/- ACRES**

- EXCELLENT MINI FARM, PERFECT FOR DREAM HOME

**TRACT 5: 3 +/- ACRES**

- BEAUTIFUL BUILDING LOT

**TRACT 6: 50 +/- ACRES**

- HIGHLY PRODUCTIVE FARMLAND WITH LARGE SPRING

**TRACT 7: 21 +/- ACRES**

- PRODUCTIVE FARMLAND WITH GOOD TIMBER

**TRACT 8: 11 +/- ACRES**

- EXCELLENT MINI FARM WITH OPEN FARMLAND & PARTIALLY WOODED

**TRACT 9: 4.3 +/- ACRES**

- GREAT BUILDING LOT

**Ready for your dream home or perfect for your hobby farm!**  
**Minutes from 68/80 Russellville, Elkton, & Clarksville, TN!**

**PRE-BIDDING STARTS SEPTEMBER 22ND AT 5 PM ON OUR WEBSITE!!**

**CONTACT THE LISTING AGENT:**

**KELVIN DEBERRY 270-602-2536 or 270-632-8882**

**Terms and Conditions:** This property will be offered in 9 (NINE) individual tracts or as a total 130 +/- acre unit. There will be a 7% Buyer's Premium added to the final bid and will be included in the total sales price. 10% as down payment on the day of the auction with the balance in cash at closing on or before closing or before 30 days. YOUR BIDDING IS NOT CONDITIONAL UPON FINANCING. Selling "AS IS, WHERE IS." ANY ANNOUNCEMENTS MADE BY THE AUCTION COMPANY AT THE AUCTION PODIUM DURING THE TIME OF THE SALE TAKE PRECEDENCE OVER ANY PREVIOUSLY PRINTED MATERIAL, OR ANY OTHER ORAL STATEMENTS MADE. See Our Website at BolingerRealEstate.com for full Terms & Conditions.